

- A comprehensive range of four-bar aluminium friction stays used for the support and frictional control of heavy duty projecting top-hung (*awning*) and side-hung (*casement*) aluminium, timber or uPVC sash windows.
- The unique bearing design and 'pull-in' patented features combined with the direct 'out-and-back' action of the HD6 series create a tight weatherproof seal around the sash. (Refer to Section Introduction.)
- The HD6 series range is designed to be housed within a 36 x 17mm cavity and to operate over a maximum upstand height of 4.0mm. (Refer to Installation Instructions.)
- Available in five sizes designated by the approximate frameplate length, the HD6 series caters for most requirements. The recommended maximum sash dimensions and weights stated below are guidelines. For full product capability refer to appropriate accompanying matrices. If your application exceeds the matrices parameters please refer to Interlock or your local distributor.
- The 450 HD6 model of this series of friction stays is primarily used in side-hung applications.
- Packed in pairs, the hand of the friction stay is determined from the window sash exterior.
- HD6 stays are manufactured to a high degree of accuracy from quality aluminium with nylon washer and support discs.
- HD6 stays are polyester/epoxy powdercoated after chemical cleaning and a chromate conversion pretreatment process.
- **TEST CRITERIA:** Tested to criteria that exceed most international standards. Test results are available upon request.
- **FINISH:** Black. Other colours are available on special order.

300mm HD6 SERIES

	APPLICATION	RECOMMENDED MAXIMUM SASH HEIGHT/WEIGHT*	OPEN <	PRODUCT No.
300 HD6	PTH	1050mm x 6.5kg	49°	P1532
300 HD6	PTH	550mm x 18kg	49°	P1532
300 HD6	PTH Restricted	300mm to 1000mm x 42kg	150mm	P1532

* Above product selection guidelines apply to the standard HD6 range only and do not necessarily apply to custom-made models. Recommendations given do not necessarily comply with the handle force requirements of NZS 4211. Refer to appropriate matrix for full product selection. Right hand illustrated in the closed position. Not to scale.

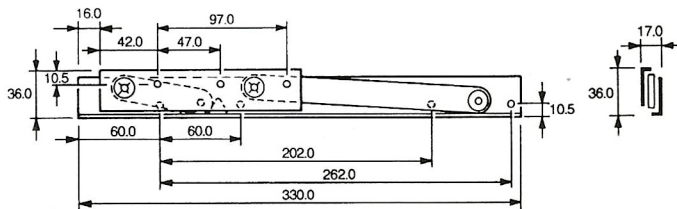

600mm HD6 SERIES

	APPLICATION	RECOMMENDED MAXIMUM SASH HEIGHT/WEIGHT*	OPEN <	PRODUCT No.
600 HD6	PTH	1600mm x 10kg	38°	P1534
600 HD6	PTH	850mm x 30kg	38°	P1534
600 HD6	PTH Restricted	1000mm to 1700mm x 71kg	150mm	P1534

* Above product selection guidelines apply to the standard HD6 range only and do not necessarily apply to custom-made models. Recommendations given do not necessarily comply with the handle force requirements of NZS 4211. Refer to appropriate matrix for full product selection. Right hand illustrated in the closed position. Not to scale.

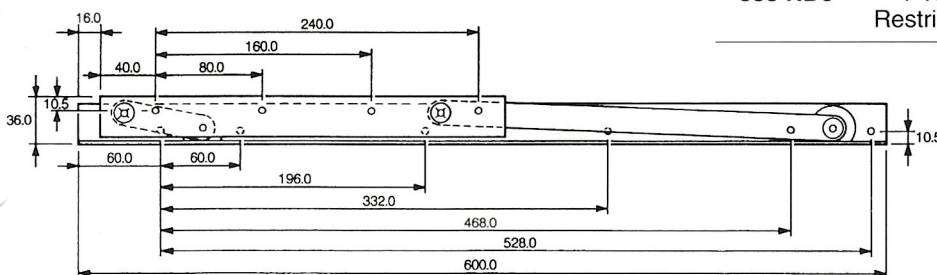

FRICTION STAYS

HD6 SERIES

750mm HD6 SERIES

	APPLICATION	RECOMMENDED MAXIMUM SASH HEIGHT/WEIGHT*	ANGLE <	PRODUCT No.
750 HD6	PTH	1800mm x 12kg	36°	P1535
750 HD6	PTH	1050mm x 36kg	36°	P1535
750 HD6	PTH Restricted	1000mm to 1700mm x 71kg	150mm	P1535

* Above product selection guidelines apply to the standard HD6 range only and do not necessarily apply to custom-made models. Recommendations given do not necessarily comply with the handle force requirements of NZS 4211. Refer to appropriate matrix for full product selection. Right hand illustrated in the closed position. Not to scale.

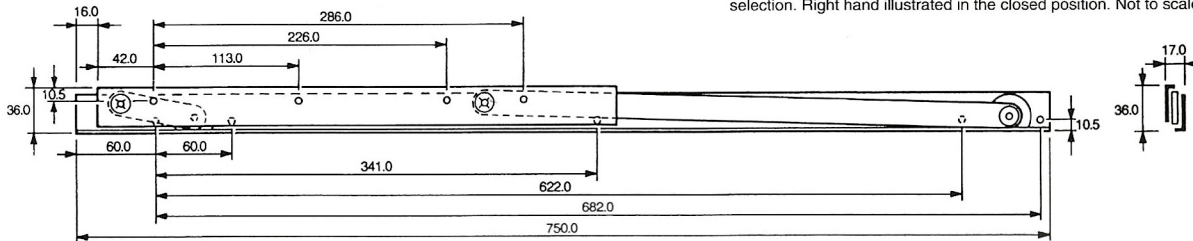

900mm HD6 SERIES

	APPLICATION	RECOMMENDED MAXIMUM SASH HEIGHT/WEIGHT*	ANGLE <	PRODUCT No.
900 HD6	PTH	2400mm x 14kg	31°	P1536
900 HD6	PTH	1300mm x 43kg	31°	P1536
900 HD6	PTH Restricted	1700mm to 2400mm x 100kg	150mm	P1536

* Above product selection guidelines apply to the standard HD6 range only and do not necessarily apply to custom-made models. Recommendations given do not necessarily comply with the handle force requirements of NZS 4211. Refer to appropriate matrix for full product selection. Right hand illustrated in the closed position. Not to scale.

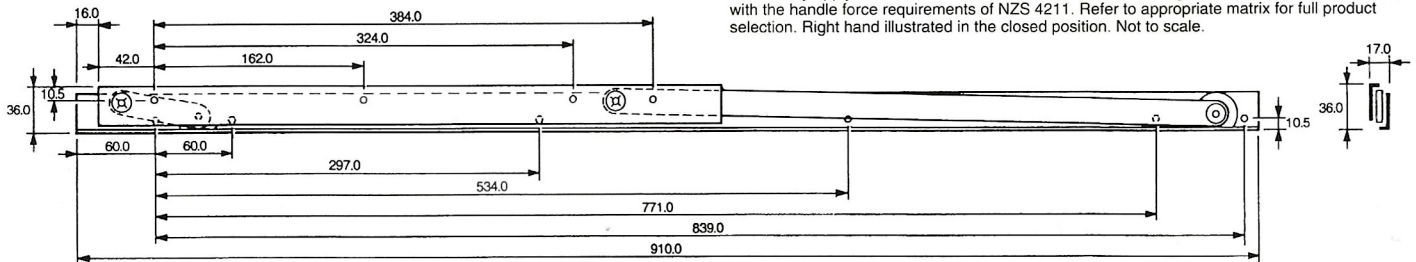

450mm HD6 SERIES

	APPLICATION	RECOMMENDED MAXIMUM SASH WIDTH OR HEIGHT/WEIGHT*	ANGLE <	PRODUCT No.
450 HD6	PSH	800mm (w) x 40kg	50°	P1533
450 HD6	PTH	600mm (h) x 21kg	50°	P1533

* Above product selection guidelines apply to the standard HD6 range only and do not necessarily apply to custom-made models. Recommendations given do not necessarily comply with the handle force requirements of NZS 4211. Refer to appropriate matrix for full product selection. Right hand illustrated in the closed position. Not to scale.

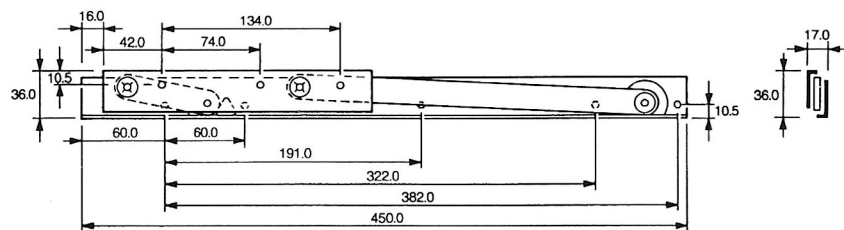

INSTALLATION INSTRUCTIONS
FIGURE 1.

FIGURE 1: The width of sash members to frame members must be set to provide a stay cavity height of 17mm. Where the 'front-to-back' dimension of the jamb cavity exceeds 36mm one baseplate (usually the frameplate) must be located away from the 'hard-back' position as in Figs 1 and 2.

FIGURE 2.

FIGURE 2: The frameplate is fixed hard up to underside of the frame cavity and parallel with the vertical plane of the frame. The sashplate should be fixed 1mm proud of the top surface of the sash.

FIGURE 3

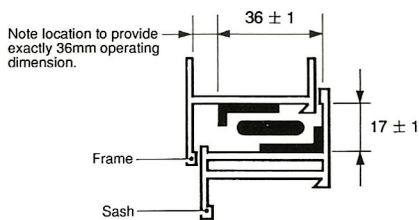
FIGURE 3: Where upstands on either the sash or frame sections protrude into the stay cavity by more than 4.0mm it may be necessary to use packers or shims to ensure that the stay arms can operate freely.

NOTE: Upon receipt of detailed cross sectional drawings or small (50mm) offcuts of sash and frame sections Interlock will provide individual installation drawings.

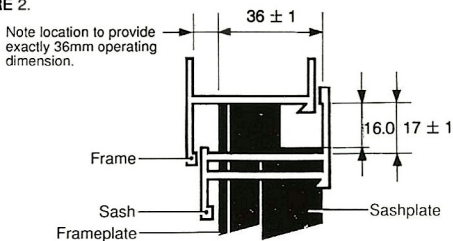
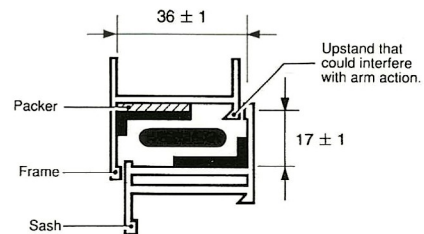
Recommended friction stay fixing – (fixings not supplied).

- 10 gauge Pan head screws
- M4 Pan head machine screws
- 4mm Truss head blind rivets